

Copyright of this drawing, the design and anything constructed from it is vested in the Architects and may not be produced without their written permission.
This design is site specific and may not be reproduced on any other site without the Architects written permission

Only figured dimensions are to be used for construction purposes. This drawing is to be read in conjunction with all relevant details for the project.
All dimensions are to be checked on site prior to commencement. Any discrepancy which may exist, if this is not acceptable to the recipient should be reported to the Architects immediately by written communication declining the acceptance of this condition.

This drawing is provided in e-mail/file format as a guide only. The user should produce their own drawings and verify all dimensions and details. The Architects do not accept any responsibility for any discrepancy which may exist, if this is not acceptable to the recipient communication declining the acceptance of this condition.

This drawing is to be used solely for planning purposes only, any other use is strictly forbidden.

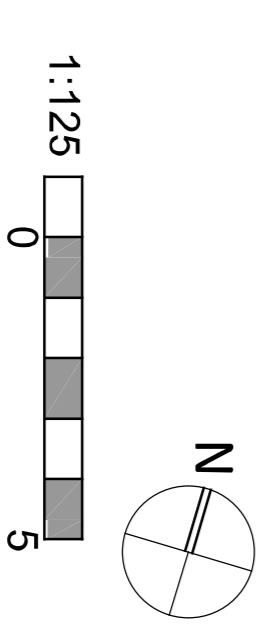
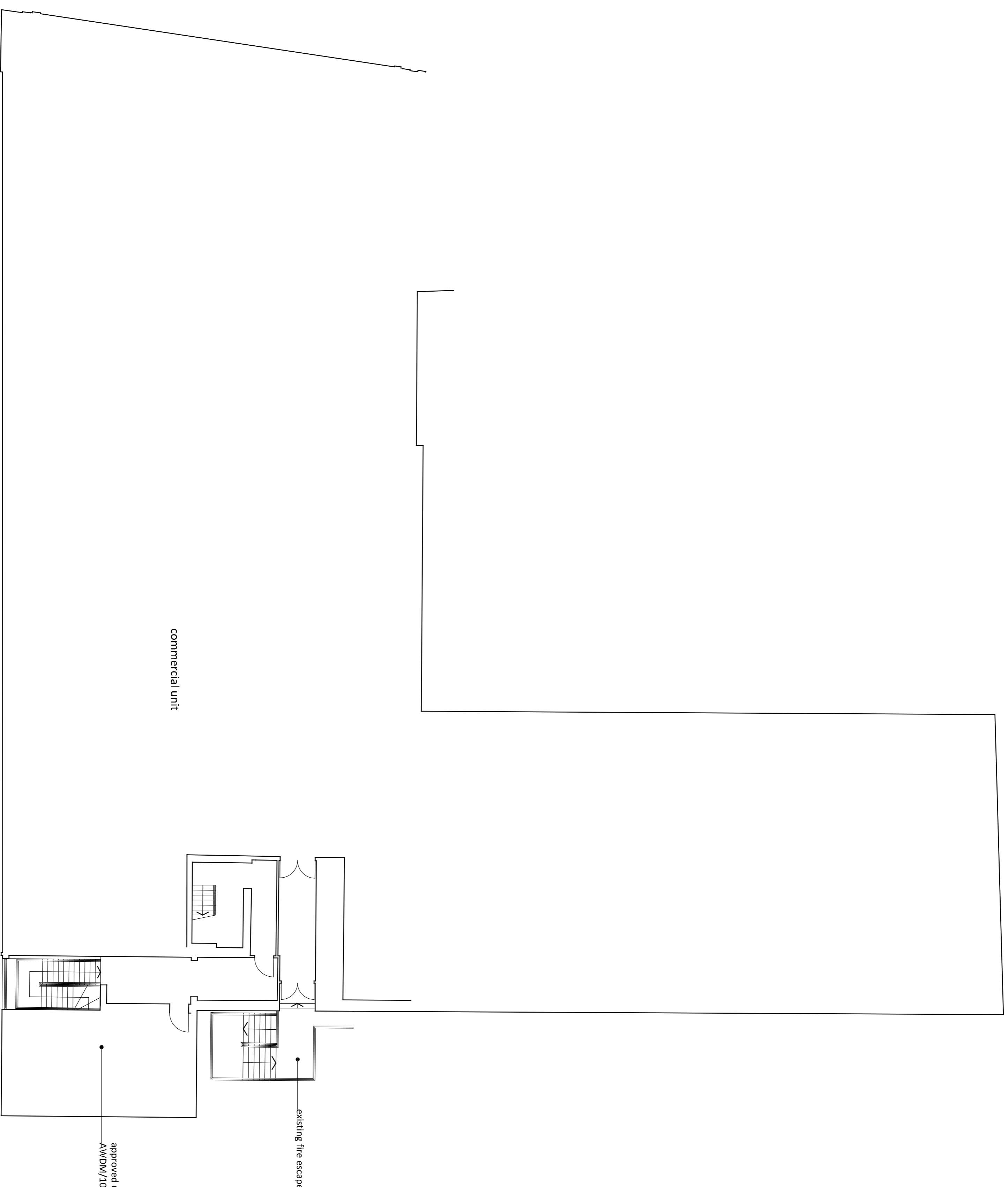

Redevelopment of eastern roof (2)

31-35 Montague Street

As proposed

First

DRAWING STATUS

Preliminary
For Approval

Tender
Construction
As Billed

Revisions

Project Redevelopment of eastern roof (2)
Client ALRMS Properties Ltd
Site 31-35 Montague Street
Title first as proposed
Scale at A1 1:125
Date Jan 24

sub rosa
architecture
54, Royal Archibank, 114
The Studios 52 Pine Avenue, Gravesend DA12 1QZ
t: 01474 262707
e: carlou@subrosa.co.uk
DRAWING NUMBER

22 - 1425 - 81